

# Lockwood Chamber of Commerce Christmas Tree Park Granite Brick Paver Campaign

The Lockwood Chamber of Commerce is offering for sale engraved granite paver bricks to raise funds for the Christmas Tree Park located on Main Street, Downtown Lockwood, MO. The funds raised will help cover the costs of additional trees, plants, landscape stones, mulch, labor and maintenance for the park. The engraved granite bricks will be incorporated in the front landing as a permanent part of the park's landscape. This is a great opportunity to honor and remember your family, children, grandchildren and loved ones for years to come. For more information regarding the Christmas Tree Park contact Russ Nentrup at 417-827-7436.

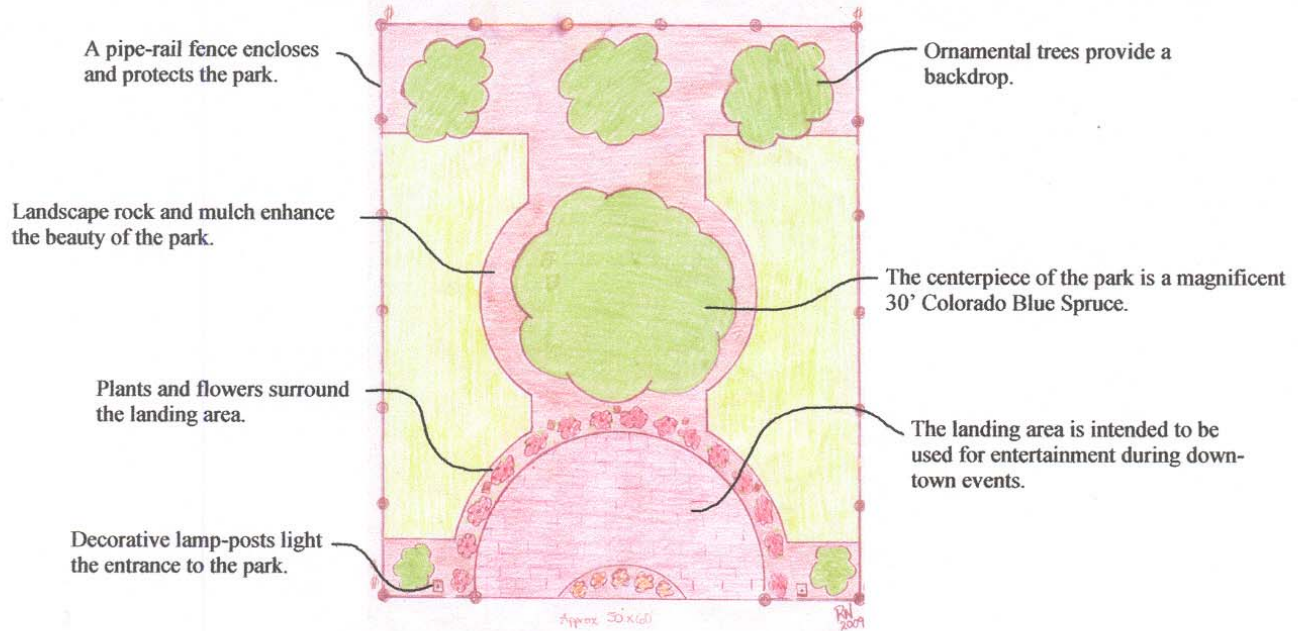

\$100 4" x 8" Bricks = 3-Lines (up to 14 characters per line including spaces)

\$250 8" x 8" Bricks = 6-Lines (up to 14 characters per line including spaces)

**Make Checks payable to Lockwood Chamber of Commerce**

Additional bricks will be discounted \$25 per brick up to 3 bricks. Multiple bricks must be purchased all together to receive discount. (Example: 1st brick = \$100, 2nd brick = \$75, 3rd brick = \$50 for a total of \$225).

Payment must be made in full at the time of ordering. Orders can be placed at participating businesses or by mail.

**Deadline is November 21st 2009**

8" x 4"	LINE #1	<input type="checkbox"/>	<input type="checkbox"/>	<input type="checkbox"/>	<input type="checkbox"/>	<input type="checkbox"/>	<input type="checkbox"/>	<input type="checkbox"/>	<input type="checkbox"/>	<input type="checkbox"/>	<input type="checkbox"/>	<input type="checkbox"/>	<input type="checkbox"/>	<input type="checkbox"/>
	LINE #2	<input type="checkbox"/>	<input type="checkbox"/>	<input type="checkbox"/>	<input type="checkbox"/>	<input type="checkbox"/>	<input type="checkbox"/>	<input type="checkbox"/>	<input type="checkbox"/>	<input type="checkbox"/>	<input type="checkbox"/>	<input type="checkbox"/>	<input type="checkbox"/>	<input type="checkbox"/>
	LINE #3	<input type="checkbox"/>	<input type="checkbox"/>	<input type="checkbox"/>	<input type="checkbox"/>	<input type="checkbox"/>	<input type="checkbox"/>	<input type="checkbox"/>	<input type="checkbox"/>	<input type="checkbox"/>	<input type="checkbox"/>	<input type="checkbox"/>	<input type="checkbox"/>	<input type="checkbox"/>
8" x 8"	LINE #4	<input type="checkbox"/>	<input type="checkbox"/>	<input type="checkbox"/>	<input type="checkbox"/>	<input type="checkbox"/>	<input type="checkbox"/>	<input type="checkbox"/>	<input type="checkbox"/>	<input type="checkbox"/>	<input type="checkbox"/>	<input type="checkbox"/>	<input type="checkbox"/>	<input type="checkbox"/>
	LINE #5	<input type="checkbox"/>	<input type="checkbox"/>	<input type="checkbox"/>	<input type="checkbox"/>	<input type="checkbox"/>	<input type="checkbox"/>	<input type="checkbox"/>	<input type="checkbox"/>	<input type="checkbox"/>	<input type="checkbox"/>	<input type="checkbox"/>	<input type="checkbox"/>	<input type="checkbox"/>
	LINE #6	<input type="checkbox"/>	<input type="checkbox"/>	<input type="checkbox"/>	<input type="checkbox"/>	<input type="checkbox"/>	<input type="checkbox"/>	<input type="checkbox"/>	<input type="checkbox"/>	<input type="checkbox"/>	<input type="checkbox"/>	<input type="checkbox"/>	<input type="checkbox"/>	<input type="checkbox"/>

**Remit payment to: Lockwood Chamber of Commerce  
PO Box 213  
Lockwood, MO 65682**

The Lockwood Chamber of Commerce reserves the right to review all engraved brick applications.